



CALL FOR BRIDGE TOLL TO COMPLETE BAY BRIDGE PATH

Congestion tolls on the Bay Bridge could pay for West Span Bicycle-Pedestrian-Maintenance Path

The current toll increase proposals are essential, but fail to address needed transportation improvements. Now is the time to address funding the West Span Bicycle-Pedestrian-Maintenance Pathway and expand transbay transit capacity.

The three toll options considered by the Bay Area Toll Authority (BATA) represent a \$160million/year surcharge to fund seismic retrofits of the Antioch and Dumbarton Bridges, make up revenues from declining traffic, and pay for increased debt financing.

We ask you to join our campaign for transportation improvements on the West Span by speaking out in support of the following proposal to “bridge the gap” between San Francisco and the Treasure Island neighborhood under development.

Modified “Congestion Pricing” Toll Option #3 to generate revenue needed to build the West Span Bicycle-Pedestrian-Maintenance Pathway & Transbay Transit Improvements:

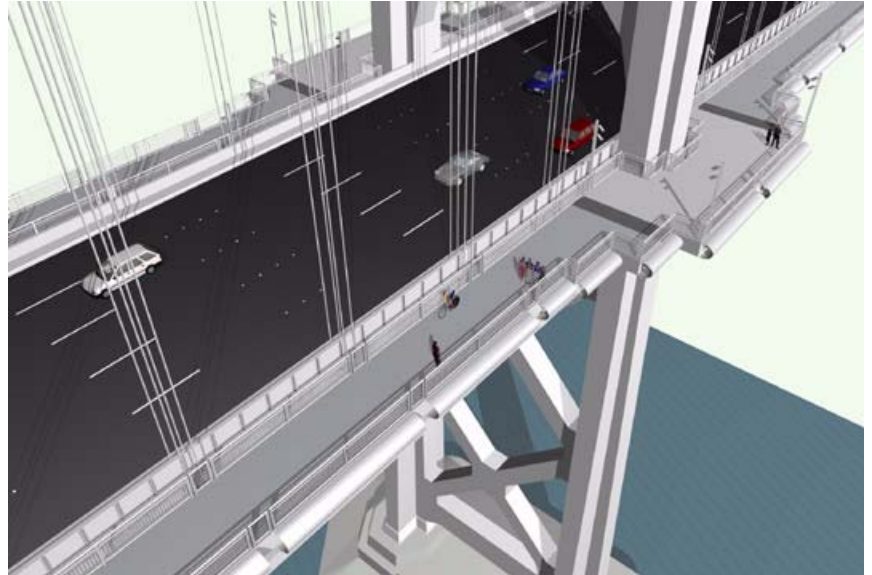

West Span Bicycle-Pedestrian-Maintenance Path would be cantilevered off both sides of the upper deck to complete the world-class bikeway all the way across the bay on the San Francisco side. Features of the path include benefits to motorists such as emergency vehicle access, refuge for stalled motorists, and reduced lane closures for bridge maintenance.

- *Set non-peak SFOBB tolls to \$5 to match tolls for other six bridges;*
- *Maintain the \$2 congestion pricing differential by establishing a \$7 peak toll.*

EBBC’s resolution supporting the completion of the path to connect

with the new East Span path has already been adopted by Emeryville, and next goes before the Berkeley City Council.

We are calling for a large turnout at 10am on Jan 27, 2010 for the Bay Area Toll Authority meeting MetroCenter Auditorium, 101 Eighth St, Oakland. 🚲 🚲 🚲

Next Meeting

EBBC’s General membership Meeting will take place for the first time since 1972 on the 3rd Wednesday (instead of Tuesday), January 20, 7:30-9:30pm at the **Rockridge Branch Library**, 5366 College Avenue in Oakland. We’ll report on many bicycle-related issues including: bridge tolls, CA legislation, federal highway bill reauthorization, and our agenda for the **January 23 Retreat** where we invite our affiliated coalition partners to help set the campaigns for 2010. One of the first successes of 2010 will undoubtedly be the opening of the street-level **Berkeley Bike Station** and EBBC’s satellite office!



Andrew Campbell, at the Fruitvale Bike Station with part of the fleet of shared bikes ready for delivery to Caltrans District 4 headquarters for use by employees.

The special presentation will focus on Bicycle Sundays with a review of the world-leading Bogotá Ciclovía project that draws about a million inhabitants to 130 km of closed streets each Sunday. A new and less ambitious program, Buenos Aires de Domingo, offers another example for the East Bay.

EBBC Office

at Fruitvale Village, 3301 E12th St, Suite 143, Oakland is the place to visit on your next bicycle trip.

Welcome New Board Members

EBBC is pleased to welcome four new Directors:

SYLVIA PAULL, from Albany, is a high-tech publicist for companies like Ask.com, CNET, and Wired magazine. She also does pro bono PR for nonprofits like the EBBC. Sylvia volunteers for Albany Strollers & Rollers, and you can often find her selling their bicycle lights at local events.

SUSAN STEWART, from Oakland, is an Exercise Physiologist in Cardiac Rehabilitation at Alta Bates Summit Medical Center. She works with patients who had heart attacks, valve repair/replacements, stents, by-pass surgeries and transplants. Susan is a member of the Veloraptors Bicycle Club and vice president of their board. She just finished a year as a member of the Ultra Marathon Cycling Association and completed 13 centuries in 2009.

JUSTICE BAXTER, from Oakland, is the owner of Wheels of Justice, an EBBC partner bike shop in the Montclair neighborhood of Oakland. Justice leads group rides and teaches basic bike repair and handling. Through Wheels of Justice, he donates time doing repairs for kids bike rodeos and Bike to Work Day, and his shop has a unique kids bike upgrade program which results in bikes donated to local charities.

MORGAN KANNINEN recently moved from Fremont to Oakland. Her current work includes collaborating on a report for TransForm on household transportation costs, and doing communications and outreach for the Sustainable Transportation Center at UC Davis. Over the past year, Morgan has taken the lead in organizing a bilingual (Spanish & English) bike collective in the Fruit-

vale area of Oakland: *El Colectivo Velo un Centro Comunitario de Bicicletas*.



Morgan working in Mexico City.

A big thank you to outgoing board members **Steve Ardrey, Eric McCaughrin, Dave Campbell and Mary Norton** - we appreciate their dedication over the past years. We'll have information on all of EBBC's board members (See p.7) available on www.ebbc.org in February. 

Imagine a country where the health care is free, the freeways are not, and cities restrict traffic entering the downtown. That country is Italy. - Michelle DeRobertis

I recently spent ten weeks in Italy and Germany studying Land Use and Transportation policy courtesy of a German Marshall Fund fellowship. You'll have to read about healthcare somewhere else, but I have been asking questions about many issues besides my narrow topic of land use density, parking and traffic impact studies. Here is a quick overview of some of the things I've learned about Torino, Genova, Milano, Stuttgart, Freiburg and Hamburg. More can be found about most of these topics on my blog at <http://cittastadt.wordpress.com>.

In Italy, *Autostrade* (freeways) do not come into the city as a general rule, they stop at the perimeter. Additionally, *Autostrade* were built under contract from the government as a user-fee funded enterprise, hence you pay to use them.

Rome was the first city in Italy, and maybe Europe, to restrict traffic--beginning in 1986 with the concept of Traffic

Limited Zones (ZTL). ZTL are different than congestion pricing because you can't buy your way in. You cannot come in with a car during certain hours unless you live there. Other cities, large and small, have their own versions of this general concept. Technology in the last ten years has significantly improved implementation and enforcement: morphing from gates and guards to video cameras and electronic sensors. Torino, being the motor city that is it, adopted the ZTL concept later than other Italian cities. Now they have an inner ring where no one can enter between 7:30 and 10:30 (unless you live there) and an outer ring where only cars rated cleaner than Euro 2 can enter (see blog). Torino is changing in January 2010 to just having one big outer ring where both rules will apply.

In Stuttgart, Hamburg and Torino there are familiar Class II bike lanes, just a plain white stripe. There are other bike-way types as well. For example, Torino

had offered generous right of way in their many wide medians and dual "medians" on almost every arterial. Now, Torino's efforts to improve bicycling depend heavily on bike paths in medians. Don't scoff. I am a big fan of median bike paths when cross traffic is controlled and there are no buses, no right-turn hooks, no car doors, and no double-left turn lanes. It is great to ride in a tree-lined and serene place within a congested city.

In sum, European city planning reflects a commitment to the density they want, where they want it, and a strong commitment to public transportation with frequent service and single ticket policies.

We can learn a lot about creating our own Transit Oriented Developments and livable cities in the Bay Area by emulating the strategies employed in the relatively car-oriented European cities I examined. 

SHORT REPORTS

VOLUNTEER - EBBC had a great season of events in 2009 and the biggest holiday party ever, thanks to a large number of volunteers who made the events both productive and enjoyable! Visit www.ebbc.org for details on the events in the coming month:

WED Jan 13 EBBC Volunteer Night
Help us prepare a mailing to members who need a reminder to renew in 2010. Food, beverage and wacky fun, 5pm to 8pm at Fruitvale Village.

SAT Jan 23 EBBC Retreat
EBBC staff, board, members and coalition partners will gather to discuss our campaigns and strategies for the coming year. Attending the annual retreat is a great way to get an in-depth look at our advocacy efforts, share your ideas for the future direction of EBBC, strengthen your ties to the bicycling community, and find out how you can get involved in making bicycling better in your town. 10am to 4pm at the Jack London Aquatic Center, 115 Embarcadero, Oakland. Please RSVP to Carrie Harvilla, 510-533-7433

MARK PENDLETON was the victim of a hit-and-run crash on McEwen Road a half-mile north of Highway 4 the evening of Nov. 24, 2008 when a large SUV crossed into his lane and struck him. Investigators credited the unrelenting pressure of family, Martinez Councilmember Mark Ross who posted a \$25,000 reward, ride partners with the Contra Costa Wells Fargo racing team, and EBBC's ghost bike led to the arrest of Harold Brown on June 2. He has since been free on bail. Over fifty family members and bicycling friends attended the Dec 21, 2009 arraignment hearing. Mark's widow Denise stated, "Brown had to stand cuffed for several minutes then was taken away in cuffs, that did my heart some good!" Brown's bail was raised \$85,000.

DANVILLE - A popular route to Mt Diablo's South Gate approach has been improved. Fresh pavement and bike lanes greet bicyclists on Green Valley Rd between Stone Valley Rd and Diablo

Road. We still need decent shoulders on Diablo Rd and repavement of the dangerous potholes on Mt Diablo Scenic Blvd, a poorly maintained private road that is an easement to the Mt Diablo State Park entrance.

COCOCO BAC - EBBC reps **Bruce "Ole" Ohlson** and **Bill Pinkham**

bemoaned the paltry applications submitted by local jurisdictions for review by the Countywide Bicycle Advisory Committee (BAC) for State funding this past December. Relatively few projects advance the Countywide Bicycle Plan. Ole suggests EBBC needs to do a better job of promoting priority projects in each jurisdiction. You can help by sharing your own "backyard" priorities with EBBC and your own Public Works department. As well, you can volunteer to serve on the Countywide BAC by contacting Mike Carlson at: mcarl@pw.cccounty.us.

NEWARK is soliciting firms to prepare their first ever Bicycle / Pedestrian Master Plan. The Newark City Council intends to form a citizen-based BPAC by March 2010 and we encourage bicycling residents and employees to volunteer by calling Soren Fajeau (510) 578-4589.

CLIMATE CHANGE - The stalemate in Copenhagen demonstrated that the political resistance to reducing fossil fuel consumption is unchanged. Despite strong encouragement from European leaders, especially Germany's Angela Merkel, the US and China will literally drive the world to destruction. Venezuela's Hugo Chavez had the best line: "If the climate was a bank, we would have already rescued it."

EMERYVILLE - On November 17th the Emeryville City Council approved an additional \$680,000 in local expenditures to design the "Interstate 80 Pedestrian Bicycle Bridge." The bridge, if funded, is projected to cost from \$11-\$26 million, and connect from the end of 65th Street to the Bay Trail. Another option to build a structure integrated with the current

and future Ashby interchange was not pursued by City Council. That option was projected to cost around \$3 million.

DUMBARTON BRIDGE - The seismic retrofit project slated to begin in 2011 will disrupt bicycle travel, but no more than it will disrupt other vehicles thanks to EBBC. The construction permit from the Bay Conservation & Development Commission also stipulates that regional bikeway signage be installed between Union City and Fremont BART Stations, through Newark and to Menlo Park on the other side of the bay. The Caltrans District 4 BAC invites local staff and BAC to discuss the project at 1:30pm on Jan 20 at 111 Grand Ave.

RUMBLE STRIPS - EBBC is urging Caltrans staff to not install shoulder rumble strips on State highways in the East Bay. Addition of rumble strips degrades the safety of bicyclists and reduces the usable shoulder area for bicycling. The California Complete Streets Act calls for all roads to consider the needs of bicyclists. The initial project proposed is Sonoma SR121. The item will be discussed at the Jan 20 Caltrans District 4 BAC.

SAFETY IN NUMBERS - We have noted that bicyclist safety is statistically enhanced where bicyclists are most numerous. Additional evidence comes from London. *The Economist* "World in 2010" reported that since 2000 London has had a 107% increase in cycle journeys and a 21% drop in casualties.

SAN LEANDRO BICYCLE PLAN - With receipt of State funding, San Leandro will prepare a bicycle plan update in 2010. We encourage citizen participation to insure that the plan meets local needs. Furthermore, ongoing involvement of these volunteer stakeholders, in the form of a Bicycle Advisory Committee, is the best way to get the plan implemented. Contact Reh-Lin Chen at (510) 577-3438.



California Environmental Quality Act (CEQA)

Amendments to the State CEQA Guidelines Addressing Analysis and Mitigation of Greenhouse Gas Emissions

For the complete text of the amendments visit:
<http://ceres.ca.gov/ceqa/guidelines/>

CEQA Amendments Adopted 12/30/2009

XVI. TRANSPORTATION/TRAFFIC -- Would the project:

a) Cause an increase in traffic which is substantial in relation to the existing traffic load and capacity of the street system (i.e., result in a substantial increase in either the number of vehicle trips, the volume to capacity ratio on roads, or congestion at intersections)? Conflict with an applicable plan, ordinance or policy establishing measures of effectiveness for the performance of the circulation system, taking into account all modes of transportation including mass transit and non-motorized travel and relevant components of the circulation system, including but not limited to intersections, streets, highways and freeways, pedestrian and bicycle paths, and mass transit?

(For more information about this victory see: *rideOn*, Nov 2009) ☸

EBBC Member Survey is alive and ready for your input now!

EBBC wants to hear how we are doing. We are interested in learning more about YOU, our member. The member survey only happens every two years.

Between **January 11-17**, visit
www.ebbc.org/2010survey.

It should take under 10 minutes to provide us with important information to help us serve you better.

As our thanks for your valuable input, we will have a drawing for an EBBC goodie bag: a one-of-a-kind, bike-friendly tote bag made of recycled materials, a bike repair manual, a set of blinky lights and more! Survey results will be shared next month. ☸

Want the latest in bicycling news in the East Bay?

Make sure that you're getting EBBC's email updates. Please send your current email address to info@ebbc.org.

EBBC MEMBERS GET DISCOUNTS AT OVER 50 AFFILIATED SHOPS

Alameda Bicycle 1522 Park St, Alameda (incl. Fruitvale & Berkeley **Bike Stations**)

Alamo Bicycles 1483 Danville Blvd

Bay Area Bikes 2424 Webster St, & rentals at Jack London Square, Oakland **NEW**

The Bent Spoke 6124 Telegraph Avenue, Oakland

Bicycle Garage 5006 Mowry Ave, Fremont

Bicycles! Pleasanton 537 Main St.

Bikes 4 Life 1344 Sunset Dr., Antioch

Brentwood Bike Company 7750 Brentwood Blvd. - Suite C

B. Spoke Tailor Temescal Farmers' Market

Cal Bicycles 2053 First St., Livermore

California Pedaler 495 Hartz Ave, Danville

Castro Valley Cyclery 20515 Stanton Ave

Crank2 5480-9 Sunol Blvd., Pleasanton

Cycle City 1433 High St., Alameda

Cycle Sports 3530 Grand Ave, Oakland

Cycle Path 337 Main St, Pleasanton

Cycles of Change APC Bike Shop, 650 W.

Ranger Ave, Alameda & The Bikery, 2285 International Blvd, Oakland

Danville Bike 175 Hartz Ave, Danville

Dublin Cyclery 7001 Dublin Blvd, Dublin

Eden Bicycles 3318 Village Dr, Castro Valley

Hank & Frank Bicycles 3377 Mount Diablo Blvd, Lafayette

Hank & Frank Bicycles 6030 College Ave, Oakland

Hayward Bicycles 22420 Foothill Blvd, Hayward

Left Coast Cyclery 2928 Domingo Ave, Berkeley

Livermore Cyclery 7214 San Ramon Blvd, Dublin & 2752 First St, Livermore

Manifesto Bicycles 421 40th St, Oakland

Mike's Bikes 2161 University Ave, Berkeley

Missing Link 1988 Shattuck Ave, Berkeley

Montano Velo 4266 Piedmont Ave, Oakland

The Pedaler 3826 San Pablo Dam Rd., El Sobrante

Pegasus Bicycle Works 415 Railroad Ave, Danville

Pioneer Bike Shop 11 Rio Vista Avenue, Oakland

Pleasant Hill Cyclery 1100-C Contra Costa Blvd, Pleasant Hill

Recycle Bicycle 3121 Sacramento St, Berkeley

rideSFO 1724 Mandela Pkwy, Oakland

Robinson Wheelworks 1235 MacArthur Blvd, San Leandro

San Leandro Cyclery 471 E 14th St, San Leandro

Schwinn City 814 A St., Antioch

Sharp Bicycle 969 Moraga Rd., Lafayette

Solano Avenue Cyclery 1554 Solano Ave, Albany

Sports Basement 1881 Ygnacio Valley Blvd, Walnut Creek

Stone's Cyclery 2320 Santa Clara Ave, Alameda

Tip Top Bike Shop 4800-A Telegraph Avenue, Oakland

Traction Bikes 1150 Contra Costa Blvd, Pleasant Hill

Velo Sport 1615 University Ave, Berkeley

Wheels of Justice Cyclery 2024 Mountain Blvd, Oakland

wheelgirl 1400 San Pablo Ave, Berkeley

Witts Bicycle Shop 22125 Mission Blvd, Hayward

wrenchscience 1022 Murray St, Berkeley

Present your EBBC membership card (clip mailing label on back cover) marked "Current" to obtain discount. Discounts vary.

Erik Jensen

Home: Berkeley
Occupation: EBBC Intern

Erik recently moved to Berkeley from Omaha, Nebraska. EBBC first met Erik at a new member meet and greet, and we got to know him as he volunteered doing valet bike parking. For the past three months, Erik has interned at EBBC, volunteering his time and smarts for a variety of projects. Our gratitude goes out to Erik - Thanks for helping to keep EBBC rolling!



Erik on Mt Diablo.

HOW DO YOU USE YOUR BICYCLE?

As a means of daily transportation, whether I'm heading into work or off camping.

WHY DO YOU RIDE?

The experience of bicycling as a means of human-paced harmonious transportation within the built and natural environment is inspiring and addictive.

HOW DO ACQUAINTANCES WHO DON'T RIDE VIEW YOU?

They worry about my safety; I worry about theirs.

WHAT BICYCLE IMPROVEMENT WOULD YOU MOST LIKE TO SEE IN THE EAST BAY?

An equitable distribution of funds for bicycle, pedestrian, transit, and automotive projects.

WHAT'S YOUR FAVORITE PLACE TO RIDE IN THE EAST BAY?

Any of Mt. Diablo's many firetrails. [Ed. note: Erik's stamina for the cold is quickly becoming legend as he heads for the summit even in Nebraska-like winter conditions.]

IS THERE ANYTHING THAT YOU DON'T LIKE ABOUT BICYCLING?

Stereotypes are too common, both outside and within our mode of transportation.

HOW MANY BICYCLES DO YOU OWN?

Three.

WHAT WORK HAVE YOU BEEN UP TO AT EBBC?

First, the member survey (see p.8)! I am also studying the MTC's routine accommodations checklist and its ability to promote consideration of complete streets throughout the East Bay; working on various website elements; and helping with outreach.

WHAT HAVE YOU ENJOYED MOST ABOUT VOLUNTEERING AT EBBC?

I love being able to tap into the shared wealth of knowledge and experience possessed by our staff and EBBC volunteers. Not only have I explored effective bicycle advocacy practice, I have developed a deep appreciation for how the bicycle can serve to catalyze meaningful transformations as we struggle to face the significant challenges of our epoch. Also, pizza.



EBBC's Velo Wonderland fun.

“Safe Routes to Transit” cont. p.8

One of the more interesting projects is a **bike sharing** program to be launched by the Valley Transportation Authority in Santa Clara. A bike sharing pilot project will start at 3-4 Caltrain stations to be determined by an initial study. Each station gets several bike-share pods from which bikes can be “rented.” If successful, the project may be expanded to BART.

Another innovative project will stripe several new bikeways to the **Glen Park BART Station** in San Francisco. The project includes counter-flow bike lanes on Lydell Street, a bicycle cut through on San Jose Avenue, the reduction of travel lane widths and removal of parking spaces to make room for bike lanes.

EBBC has been coordinating the Safe Routes to Transit Program since 2005 and is seeking additional funding for the program in the next Regional Transportation Plan. MTC is limiting proposed new funding to “evaluation” of the program, rather than new capital projects. Please check out our website for the latest details on how you can help.



Minutes

of the Board & General Membership Meetings on Nov 17, 2009. Rockridge Branch Library, 5366 College Ave

Draft for Approval

Board members present: - Dave Campbell (Chair), Steve Ardrey, Tom Ayres, Bill Pinkham, Ole Ohlson, Leo Dubose, Rick Rickard, Dave Favello

Staff: Robert Raburn, Carrie Harvilla

Also: Hal, Eisen, Erik, Ian McDonald,

EBBC BOARD OF DIRECTORS

Board members

Steve, Mary, Eric, and Dave C are stepping down

4 nominees (proposed by sub-committee, contacted, found to be willing and interested) – Susan Stewart, Justice Baxter, Morgan Kenninen, and Sylvia Paul

Rick will continue as treasurer, Tom as secretary, Bike Dave as Vchair

For chair: Tom volunteers to take this on if someone else will be secretary – remains to be worked out

Treasurer

No report this month because our book-keeper just had a baby. Rick is working on getting access to the accounts with quick-books. For 2010, he assumes we will have 2 offices (increased expense), but possibly only 4 newsletters per year (reduced cost).

Budget for Bike to Work Day – Dave Campbell

Presents a budget – generally the same as BtWD 2009, with ~\$10k extra from ACCMA (Alameda Co. CMA). Notes that memberships received at the Bike Away from Work Party are not listed as income in the budget, since those relate to the ongoing growth of the EBBC, even though a number of memberships are obtained at that time. Several people agreed that income should not be included in the BtWD budget, but we will track the amount of income involved so we can evaluate the financial impact of the event.

Suggestion was made to make the Bike Away from Work Party a separate event, for budgeting, with costs and income to be considered separately from the rest of BtWD.

Motion to authorize Dave to begin spending on BtWD on the current temporary budget, to be revisited later: APPROVED

Maps

Robert reports that we have received 2 pallets of the new 2009 revision of *West of the Hills*. We have paid the last portion of the contract. For the future, we will be looking into a digital project. Robert would like approval for Greg Tanaka of Valley Map-

ping to begin work on that project, with up to \$3k to begin. APPROVED

SHORT REPORTS

T-shirts - Carrie requests ~\$1k to print up new t-shirts – Beautiful Machine – says a prototype she has worn to summer events was well received. Motion to authorize - APPROVED

Assistant Education Coordinator – Dave C says we are reviewing resumes to hire someone to work on a part-time basis on bike safety classes, etc. More on this in January.

Retreat Jan 23 – Save this date for our annual retreat – details forthcoming.

Third Wed Meetings in 2010 – In the coming year – at least for the first 2 months - we will have our meetings on the 3rd Wednesday, rather than our long tradition of 3rd Tuesday. Feedback will be appreciated. Rick notes that this change will need to be addressed in a change to the by-laws.

GENERAL MEMBERSHIP

Introductions (n=30)

Board elections

Slate of 11, including Tom Ayres as Chair, Sylvia Paul as Secretary, Rick Rickard as Treasurer and Dave Favello as Vice Chair – ELECTED. Thanks to the ad hoc sub committee that identified and vetted potential nominees.

Bridge toll increase and West Span Bicycle/Pedestrian/Maintenance Path campaign

Robert reports. The Bay Area Toll Authority hopes to raise \$160 million per year for seismic retrofits (Antioch & Dumbarton) etc. They are considering various types of toll increases. One of the options includes a congestion pricing scheme, with the auto toll on the SF Oakland Bay Bridge at \$6 in peak hours, \$5 weekends, \$4 non-peak. A modified option would use \$5 as the non-peak toll and \$7 peak.

The Caltrans feasibility study in 2001 found the best solution for bike/ped/maintenance access would be to put out-board paths on both sides of the west span. BATA has funded an update of the 2001 study for engineering designs and cost estimates. A big push of support will be needed in the next several months to get the go-ahead for the path. Motion for EBBC to support the modified 3rd toll option, in order to generate

revenue for the WSBPMP (along with the other 3 projects): APPROVED

Calaveras Road closure and EBBC suggestions

Construction of the dam in 2011 will stir up asbestos, closing the Calaveras Wilderness for 2 years. The Calaveras Road will be closed during weekdays because of heavy equipment. Robert notes that the road will need to be maintained (e.g., swept) so that it will be safe for bicycles when the road is open on weekends; we also urge that it be available for the Primavera Century (Fremont Freewheelers) and for the Amgen Tour of California (which comes through on a weekday). Finally, Robert notes that we don't have access over Sunol Grade; there is not access except by freeways. We need a bridge over Alameda Creek on Paloma Road, giving access to Andrade, Sheridan, and Mission Pass roads. Funds would come from contingency set-asides for mitigation.

Motion to support mitigation for these 4 needs: APPROVED

Save Safe Routes to Transit funding

Janel Sterbentz (Bay Area Bicycle Coalition) says we are seeking \$50 million for Safe Routes to Transit – to facilitate non-motorized access to transit stations. This is funding that had been promised by the Regional Transportation Plan of the MTC for the next 5 years. A petition of support is available at the BABC site – there is a link at the EBBC site – all are urged to send letters. Supporters are encouraged for the Dec 9 meeting of the MTC, or submit comments (savesrt2@bayareabikes.org).

Velo Wonderland Dec 4

Carrie urges all to attend this EBBC party, with friends, including folks who are not (yet) EBBC members. There will be bike-themed and recycled art, a DJ, beer, snacks, deserts. Volunteers are needed to help make this a success. The beer will be from the Linden St. brewery, which has a special cargo bike to deliver kegs; they are making a batch of Velo Wonderland Winter Lager for the event.

State Park access

Robert notes that California State Parks Foundation is sponsoring an \$18 per car fee, giving access (free parking) at state parks, with funds to go to support keeping the parks open. In the meantime it appears that parks critical to cycling in the east bay are still likely to be open, so the state park access issue is not directly relevant to the EBBC.

- Secretary Tom Ayres

CONTACT EBBC

www.ebbc.org

Fruitvale Village, 3301 E12th St, #143
MAIL: PO Box 1736, Oakland 94604

Executive Director Robert Raburn
510-533-7433 robertraburn@ebbc.org
Outreach Coordinator Carrie Harvilla
510-533-7432 carrie.harvilla@ebbc.org
Program Director Dave Campbell
510-701-5971 dcampbel@lmi.net

EBBC OFFICERS & BOARD MEMBERS

Chair Tom Ayres Kensington
510-528-4941 . . . TJAyres@sbcglobal.net
Vice Chair "BikeDave" Favello Walnut Crk
925-939-9462 davevelo@mac.com
Secretary Sylvia Paull Albany
510-547-1116 whoisylvia@aol.com
Treasurer Rick Rickard Oakland
510-482-5968 rrick1@mindspring.com
Leo Dubose Oakland
Craig Hagelin Walnut Creek
Susan Stewart Oakland
Morgan Kenninen Oakland
Bruce "Ole" Ohlson Pittsburg
Bill Pinkham Richmond
Justice Baxter Oakland (Montclair)

EBBC VOLUNTEERS

Hazard Elimination Reports Ian MacDonald
510-832-6300 ian@roycmdonald.com
EBBC Map Distribution Derek Liecty
510-339-2345 spoker@sbcglobal.net
Web Eric McCaughrin webmaster@ebbc.org

COALITION PARTNERS

AFFILIATED RIDE CLUBS

Berkeley Bicycle Club www.berkeleybike.org
Bicycle Trails Council of the East Bay
510-466-5123 www.btceastbay.org
Brentwood Bike Club <http://brentwoodbikeclub.org>
Cherry City Cyclists Steve Yoder 510-357-3045
<http://www.cherrycitycyclists.org>
Delta Pedalers Dave Stoeffler 925-634-1793
<http://www.deltaped.org>
Diablo Cyclists <http://www.diablocyclists.com>
Different Spokes Derek Liecty 510-339-2345
Fremont Freewheelers Jeff Girard
510-414-0114 <http://fremontfreewheelers.org>
Grizzly Peak Cyclists Al Forkosh 510-655-4221
<http://GrizzlyPeakCyclists.org>
Golden Gate Cyclists
<http://www.goldengatecyclists.org>
Hikanbyke Niels Poulsen 510-375-1521
<http://www.hikanbyke.org>
Oakland Yellowjackets 510-986-9011
<http://www.oaklandyellowjackets.org>
Velo Raptors (Montclair)
Ron Scrivani scrivanir@aol.com
Santa Rosa Cycling Club
Bill Oetinger srcc@metro.net
Strada Sempre Duro Rick De Gette 925-944-7049
Valley Spokesmen Jim Kohnen 925-828-3623
<http://www.valleyspokesmen.org>

AFFILIATED ORGANIZATIONS

Albany Strollers & Rollers www.albanystrollroll.org
Nick Pilch 510-525-4841
Bay Area Bicycle Coalition www.bayareabikes.org
Andrew Casteel, ED andrew@bayareabikes.org
Bay Trail Project <http://www.abag.ca.gov>
Laura Thompson, Proj Mgr 510-464-7935
BikeAlameda <http://www.bikealameda.org>
Lucy Gigli 510-595-4690
Bicycle-Friendly Berkeley Coalition (BFBC)
Phil Morton www.bfbc.org

CA Association of Cycling Organizations

<http://www.cabobike.org/index.htm>
California Bicycle Coalition (CBC) www.calbike.org
David Hoffman, Exec Dir 412-576-5982
Cycles of Change www.cyclesofchange.org
Greenbelt Alliance www.greenbelt.org
Cristina Wong cwong@greenbelt.org
PTownBikeAdvocates (Pleasanton)
James Van Dyke 925-462-0706
jvdleftcoaster@yahoo.com
Richmond BPAC www.richmondbpac.org
TransForm <http://www.transcoalition.org>
Stuart Cohen, Exec Dir 510-740-3150
Urban Ecology www.urbanecology.org
Walk Oakland Bike Oakland (WOBO)
www.walkoaklandbikeoakland.org
Waterfront Action www.waterfrontaction.org

COMMUNITY REPS & ADVOCATES

BART Bicycle Advisory Task Force
<http://www.bart.gov/guide/bikes>
CoCoCo Reps:
Dave Favello (Chair) davevelo@mac.com
Craig Hagelin chagelin@astound.net
Alameda Co Reps:
Mike Jones mkjcal@hotmail.com
Janel Sterbentz janel@bayareabikes.com
Brentwood Dave Stoeffler 925-634-1793
Fremont Michael Graff 510-713-7441
michael.graff@pobox.com
Lamorinda
Bart Carr Bart_Carr@yahoo.com
Martinez Dick Anderson 925-372-5889
Pittsburg Bruce "Ole" Ohlson 925-439-5848
bruceoleohlson@hotmail.com

You can help in any of 33 cities in the East Bay.

EAST BAY BICYCLE COALITION annual membership form

Keep current! Send your tax-deductible donation to **EBBC, PO Box 1736, Oakland, CA 94604**
EBBC's accounting methods assure that your early payment will extend your membership by a year.

Name _____

Address _____

City, State, Zip _____

Phone/Fax _____

E-mail Address (EBBC guards your privacy) _____

Workplace/City _____

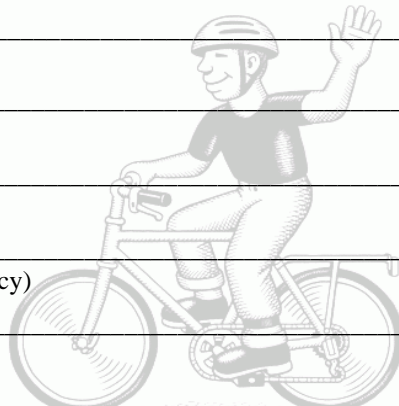

Commuter Utility Recreation Touring Transit User Other bicycling interests?

Membership Type

- Sustaining (\$25)
- Household (\$40)
- Half-century (\$50)
- Century (\$100)
- Introductory (\$12)
- 4hr Pledge (\$6)
- Endow (\$_____)

- New
- Renewal

- Never share my name with others
- Only share with EBBC affiliates

\$4.2 Million Programmed for Safe Routes to Transit

- Dave Campbell

Improved bike/ped access is coming to the **San Leandro BART Station**, bike lanes are going to be striped on **40th Street/41st Street** and **W. MacArthur Blvd** leading to MacArthur BART, **Nevin Avenue** in Richmond is getting an overhaul that will connect Richmond BART to the city's new civic center, bicycle kiosks are coming to **Berkeley**, **Bayfair BART** will be made safer for pedestrians and new bicycle signage and way finding signs are to be designed for **West Contra Costa County**. It's all part of the 3rd cycle of Safe Routes to Transit funding.



40th St at MacArthur BART - a great start!

11 approved projects received the highest scores and can receive their money immediately.

The **MacArthur BART Station** project received initial neighborhood push back on the idea of narrowing the median on 40th Street to make room for bike lanes. Oakland staff has modified the project to address this concern by proposing to reconfigure turn pockets and thereby expand the overall planted areas in the medians. Sidewalk tree plantings are also proposed. Additional public outreach will occur this Spring

In December 2009, the Metropolitan Transportation Commission approved \$4.2 million for 11 projects throughout the Bay Area. 35 applications totaling \$14 million were reviewed by the East Bay Bicycle Coalition and TransForm last Fall. The

on the alternatives being considered for 40th Street.

“Safe Routes to Transit” cont. p.2

Printed on 100% recycled paper



Newsletter Notes: *rideOn* is published monthly by the East Bay Bicycle Coalition, a non-profit tax-exempt organization dedicated to promoting bicycling as an everyday means of transportation and recreation throughout Alameda and Contra Costa counties since 1972. Logo design by Martha McNulty.



Non-Profit
US Postage
PAID
Oakland, CA
Permit #847

EAST BAY BICYCLE COALITION
POST OFFICE BOX 1736
OAKLAND, CA 94604

